

Enlarged view of shaft sleeve and mechanical seal area.

Parts Pricing

| | Key # | | |
|---------------------------------------|-------|--|-----------|
| 11 27 01 | #1 | Motor | POR |
| 11 27 02 | #2 | Flinger | \$11.95 |
| Bracket | | | |
| 11 27 03 | #3 | 5VMC-S2, T, T5, & 75VMC-T, T5 | \$400.20 |
| 11 27 04 | | 75VMC-S2, 10VMC-S2, T, T-5 | \$910.60 |
| 11 27 05 | | 5VMB-S2, T, T5 & 75VMB-T, T5 | \$609.00 |
| 11 27 06 | | 75VMB-S2, 10VMB-S2, T, T5 | \$1396.20 |
| 11 27 07 | #4 | Hex Cap Screw 3/8-16 X 7/8" L | \$5.68 |
| | | 5 & 7 1/2 VM 4-Pack | |
| 11 27 08 | | Hex Cap Screw 1/2-13 X 1 1/4" L - 4-Pack | \$9.86 |
| Sleeve | | | |
| 11 27 09 | #5 | 5VMC-S2, T, T5 & 75VMC-T, T5 | \$207.64 |
| | | 5VMB-S2, T, T5 & 75VMB-T, T5 | |
| 11 27 10 | | 75VMC-S2 & 10VMC-S2, T, T5 | \$226.20 |
| | | 75VMB-S2 & 10VMB-S2, T, T5 | |
| 11 27 11 | #6 | O-ring 1" x 1-1/8" | \$1.74 |
| 11 27 12 | #7 | Mechanical Seal Assembly | \$90.48 |
| 11 27 13 | #8 | Washer | \$37.70 |
| 11 27 14 | #9 | Shim X .031 | \$16.82 |
| 11 27 15 | | Shim X .020 | \$16.82 |
| 11 27 16 | | Shim X .010 | \$16.82 |
| Impellor | | | |
| 11 27 17 | #10 | 5VMB | \$614.80 |
| 11 27 18 | | 5VMC | \$493.00 |
| 11 27 19 | | 75VMC-S2 | \$551.00 |
| 11 27 20 | | 75VMC-T, T5 | \$551.00 |
| 11 27 21 | | 75VMB-S2 | \$649.60 |
| 11 27 22 | | 75VMB-T, T5 | \$649.60 |
| 11 27 23 | | 10VMC | \$551.00 |
| 11 27 24 | | 10VMB | \$649.60 |
| 11 27 25 | #11 | Adaptor | \$56.84 |
| 11 27 26 | #12 | Dowel Pin | \$12.53 |
| 11 27 27 | #13 | Gib Key | \$21.69 |
| 11 27 28 | #14 | Washer | \$1.39 |
| 11 27 29 | #15 | Cap Screw 3/8-16 X 1" L | \$6.61 |
| Case with Wear Ring & Plug | | | |
| 11 27 30 | #16 | VMC | \$1154.20 |
| 11 27 31 | | VMB | \$2378.00 |
| 11 27 32 | #17 | Wear Ring | \$161.24 |
| 11 27 33 | #18 | Plug 1/4" NPT Galv, VMC | \$2.09 |
| 11 27 34 | | Plug 1/4" NPT Brass, VMB | \$4.18 |
| 11 27 35 | #19 | Gasket | \$15.08 |
| 11 27 36 | #20 | Index Pin | \$12.76 |
| 11 27 37 | #21 | Gasket | \$12.18 |
| Strainer Body | | | |
| 11 27 38 | #22 | VMC | \$1154.20 |
| 11 27 39 | | VMB | \$2314.20 |
| 11 27 40 | #23 | Grommet -8 Pkg | \$74.24 |
| Hex Cap Screw 3/8-16 X 7/8" L | | | |
| 11 27 41 | #24 | VMC -8 /Pkg | \$5.68 |
| 11 27 42 | | VMB-8/Pkg | \$10.09 |
| 11 27 43 | #25 | Strainer Basket | \$493.00 |
| Strainer Cover | | | |
| 11 27 44 | #26 | VMC | \$145.00 |
| 11 27 45 | | VMB | \$342.20 |
| 11 27 46 | #27 | Plug 1/4" NPT-Galv, VMC | \$2.09 |
| 11 27 47 | | Plug 1/4" NPT- Brass VMB | \$4.18 |
| 11 27 48 | #28 | O-ring 7-1/4" X 7-3/4" | \$15.08 |
| 11 27 49 | #29 | Lock Knob Assembly, pair - Base | \$63.80 |
| 11 27 50 | #30 | 5VM, 75VM-T | \$145.00 |
| 11 27 51 | | 75VM-S2, 10 VM | \$261.00 |
| 11 27 52 | #31 | Hex cap screw 3/8-16 X 1" L 4-Pkg | \$5.68 |
| 11 27 53 | #32 | Washer 3/8"-4/Pkg | \$2.90 |
| Wet Ends | | | |
| 11 27 54 | | VMC Wet End | \$3498.00 |
| 11 27 55 | | VMB Wet End | \$5596.80 |

Jacuzzi End-Suction Centrifugal Pumps

FEATURES

Very efficient pumps that move huge amounts of water at low pressure. Shut off heads are also low, perfect for fiberglass filters with low pressure ratings.

CASINGS

Cast iron construction, tapped for drain, vent cock and pressure gauge. Suction and discharge connections are standard ASA flanged type for easier installation. These pumps are of the back pull-out design to permit removal of the motor and all rotating parts without breaking the suction and discharge connections. Discharge can be field rotated for 45° position change.

IMPELLER

Single piece enclosed bronze fully balanced with the diameter cut for the specific condition points. Impeller is keyed to the shaft. High head units have back of impeller vented suction to achieve hydraulic balance, limit thrust load and reduce pressure in the seal.

SHAFT

Shaft is heat treated carbon steel, turned and ground.

SHAFT SLEEVE

Renewable stainless steel shaft sleeve prevents contact between the shaft and the liquid being pumped. Sleeve is keyed to motor shaft.

WEARING RING

Renewable bronze wearing ring pressed into the pump casing is standard.

MECHANICAL SHAFT SEALS

Leakless mechanical shaft seals with ceramic and carbon faces, plus stainless steel components eliminate maintenance and adjustment problems.

INSTALLATION

Pumps may be mounted horizontally, vertically or in any angular position.

MOTORS

Standard drip proof NEMA motors are used. Motor bearings are factory lubricated and sealed for long life without field lubrication. Standard JM, JP and TCZ closed coupled pump motors are utilized for ease of replacement and to provide a short shaft overhang, reducing the effect of axial strain on the motor bearings.

All pumps quoted with 208/230/460 3ph. motors. Other voltages available

on request. Larger pumps, up to 75hp quoted on request.

| Item No | | SxD | RPM | Price |
|----------|--------|---------|------|-----------|
| 11 27 55 | R5FL6 | 8" x 6" | 1750 | \$4645.50 |
| 11 27 54 | R75FL6 | 8" x 6" | 1750 | \$4746.00 |
| 11 27 53 | R10FL6 | 8" x 6" | 1750 | \$4901.00 |
| 11 27 50 | R15FL6 | 8" x 6" | 1750 | \$5199.00 |
| 11 27 51 | R20FL6 | 8" x 6" | 1750 | \$5445.00 |
| 11 27 52 | R25FM6 | 8" x 6" | 1750 | \$POR |

Capacities in US GPM Total Head in Feet

| Model | HP | 40 | 45 | 50 | 55 | 60 | 65 | 70 | 75 | 80 | Shut Off Head/PSI |
|--------|----|------|------|------|------|------|------|------|------|-----|-------------------|
| R10FL6 | 10 | 890 | 805 | 680 | 440 | 100 | | | | | 61/28 |
| R15FL6 | 15 | 1165 | 1120 | 1035 | 1000 | 910 | 800 | 630 | 300 | - | 78/34 |
| R20FL6 | 20 | - | 1250 | 1210 | 1160 | 1105 | 1040 | 950 | 840 | 300 | 89/38.5 |
| R25FM6 | 25 | - | 1525 | 1480 | 1420 | 1345 | 1260 | 1155 | 1020 | 520 | 89/38.5 |



Fiberglass filters are typically rated at 50 PSI. These pumps have low shut off pressures to prevent filter damage or failure and are very efficient in pool operating ranges.

JACUZZI PUMP PARTS ON REQUEST



C Series Commercial Brass Pump



WITH HAIR AND LINT POT

Brass volute and pot, coated cast iron foot, flanged connections, 6 inch suction, 4 inch discharge.

- Large commercial pump with stainless steel basket
- Easy serviceability
- All-bronze construction for strength and durability
- 6 inch suction and 4 inch discharge for maximum capabilities
- Self-priming to ensure proper filtration
- Heavy gauge stainless steel strainer basket with an open area 14 times the area of the suction port
- Closed impeller for longer motor bearing life
- Heat-resistant seal capable of operation at up to 200° F
- Also available in 200/208V, 3 phase and 575V, 3 phase
- One year warranty
- Low shut off head 60 PSI

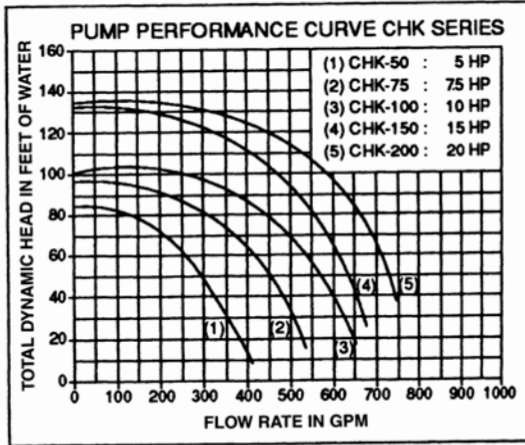

| Item No. | Model | Description | H.P. | Price |
|----------|--------|-------------|------------|-----------|
| 11 27 60 | 011657 | CHK 50 | 5 H.P. | \$6970.16 |
| 11 27 61 | 011658 | CHK 75 | 7 1/2 H.P. | \$7134.84 |
| 11 27 62 | 011659 | CHK 100 | 10 H.P. | \$7984.60 |
| 11 27 63 | 011660 | CHK 150 | 15 H.P. | \$8472.85 |
| 11 27 64 | 011661 | CHK 200 | 20 H.P. | \$9850.90 |

208/230/460 3 ph quoted above

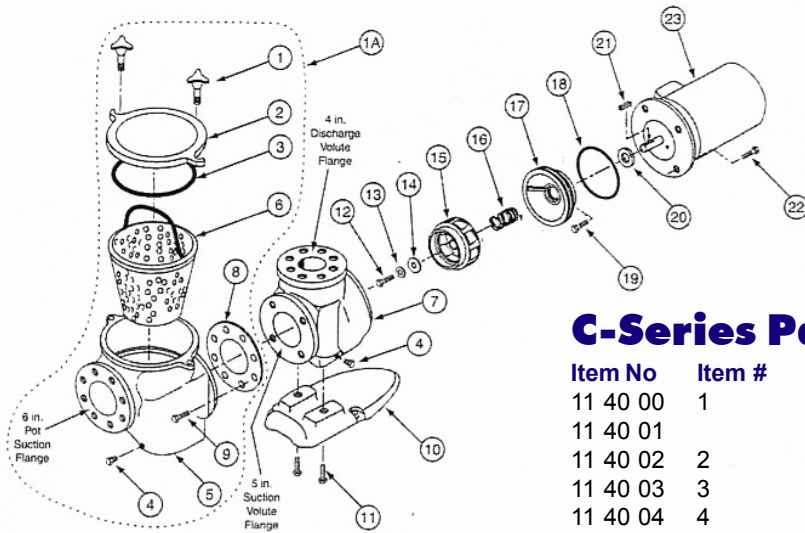

C-Series Parts

| Item No | Item # | Part no | Description | Price |
|---|--------|---------|-----------------------|-----------|
| 11 40 00 | 1 | 075280 | Bronze Knob | \$144.37 |
| 11 40 01 | | 072747 | Pot Assembly | \$6653.00 |
| 11 40 02 | 2 | 075275 | Strainer Lid | \$1047.00 |
| 11 40 03 | 3 | 071433 | Cover O-ring | \$10.05 |
| 11 40 04 | 4 | 071551 | Bronze plug 1/4" | \$5.95 |
| 11 40 05 | 5 | 075271 | Pot Only | \$5040.00 |
| 11 40 06 | 6 | 072795 | SS Basket | \$500.54 |
| 11 40 07 | 7 | 075273 | Volute | \$4972.00 |
| 11 40 08 | 8 | 070943 | 5" Flange Gskt | \$30.84 |
| 11 40 09 | 9 | 071683 | Screw 4 req. | \$38.52 |
| 11 40 10 | 10 | 075287 | Foot Coated | \$110.79 |
| 11 40 11 | 11 | 071688 | Screw 2 req. | \$2.02 |
| 11 40 12 | 12 | 071037 | Impellor Lock Screw | \$6.84 |
| 11 40 13 | 13 | 071048 | Impellor Washer | \$15.47 |
| 11 40 14 | 14 | 075713 | Impellor Washer Gskt | \$1.61 |
| 11 40 15 | 15 | 07---- | Impellor: Note- Order | \$1642.00 |
| Must include model, (CH or CM), HP, Volts, & Phases | | | | |
| 11 40 16 | 16 | 071725 | Mechanical Seal | \$56.42 |
| 11 40 17 | 17 | 070906 | Flange | \$715.11 |
| 11 40 18 | 18 | 071423 | O-ring | \$4.00 |
| 11 40 19 | 19 | 071681 | Screw 2 req. | \$1.51 |
| 11 40 20 | 20 | 072185 | Water Slinger | \$10.62 |
| 11 40 21 | 21 | 071046 | Impellor Key | \$26.90 |
| 11 40 22 | 22 | 071687 | Screw 4 req. | \$6.68 |