



## C Series Commercial Brass Pump

### WITH HAIR AND LINT POT

Brass volute and pot, coated cast iron foot, flanged connections, 6 inch suction, 4 inch discharge.

- Large commercial pump with stainless steel basket.
- Easy serviceability.
- All-bronze construction for strength and durability.
- 6" suction and 4" discharge for maximum capabilities.
- Self-priming to ensure proper filtration.
- Heavy gauge stainless steel strainer basket with an open area 14 times the area of the suction port.
- Closed impeller for longer motor bearing life .
- Heat-resistant seal capable of operation at up to 200° F.
- Also available in 200/208V, 3 phase and 575V, 3 phase.
- One year warranty.
- Low shut off head 60 PSI.

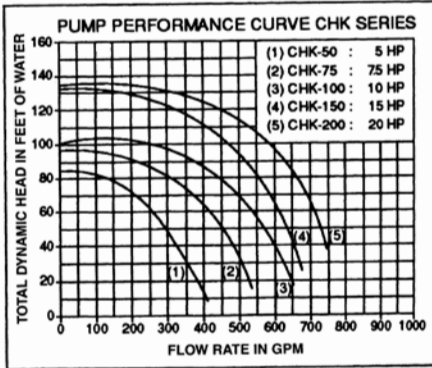

Model	Description	H.P.	Price
011657	CHK 50	5 H.P.	POR
011658	CHK 75	7 1/2 H.P.	POR
011659	CHK 100	10 H.P.	POR
011660	CHK 150	15 H.P.	POR
011661	CHK 200	20 H.P.	POR

208/230/460 3 ph quoted above

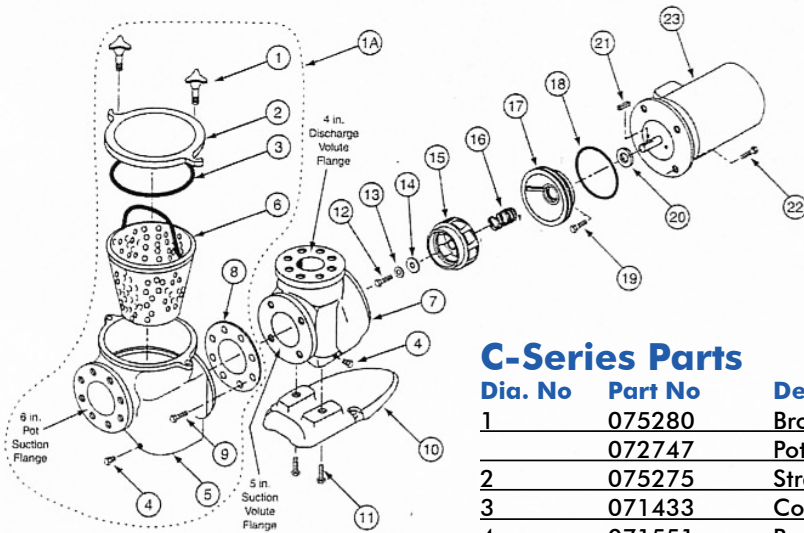

## C-Series Parts

Dia. No	Part No	Description	Price
1	075280	Bronze Knob	\$152.31
	072747	Pot Assembly	\$7018.92
2	075275	Strainer Lid	\$1104.95
3	071433	Cover O-ring #452	\$18.41
4	071551	Bronze plug 1/4"	\$6.28
5	075271	Pot Only	\$5317.20
6	072795	SS Basket	\$528.07
7	075273	Volute	\$5245.46
8	070943	5" Flange Gskt	\$32.54
9	071683	Screw 4 req.	\$40.64
10	075287	Foot Coated	\$116.88
11	071688	Screw 2 req.	\$2.13
12	071037	Impellor Lock Screw	\$7.22
13	071048	Impellor Washer	\$16.32
14	075713	Impellor Washer Gskt	\$1.70
15	07----	Impellor: Note- Order Must include model, (CH or CM), HP, Volts, & Phases	\$1732.31
16	071725	Mechanical Seal	\$59.52
17	070906	Flange	\$754.44
18	071423	O-ring	\$4.22
19	071681	Screw 2 req.	\$1.59
20	072185	Water Slinger	\$11.20
21	071046	Impellor Key	\$28.38
22	071687	Screw 4 req.	\$7.05