

TR 100C & TR 140C Replacement Parts

Dia #	Part #	Description	Price
3	273564	Manual Air Relief Assembly	\$140.00
4	100-60	Back Mount Gauge	\$18.50
5	273513	O-ring for Air Bleed	\$ 1.20
7	154575	Closure Dome, 8 1/2"	\$87.00
27	154527	Wrench for 8 1/2" closure	\$39.00
8	152509	Dome Square O-ring	\$9.60
13	154412	2" Nut for Air Relief	\$12.80
19	274494	Drain O-ring	\$6.30
20	152220Z	Drain Assembly	\$58.00

All parts not listed are in common with the regular filters, see previous page.

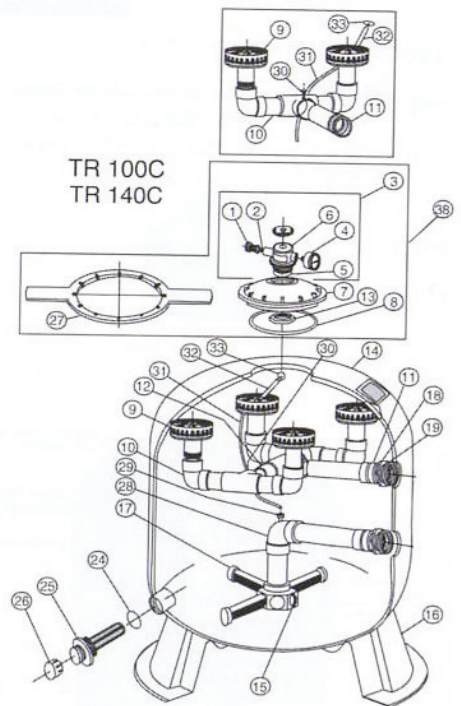

Astral Laterals - Old Style

Part No	Description	Price
00629	100mm long-threaded both ends	\$8.85
00628	110mm long-closed one end	\$8.85
00627	160 mm long-closed one end	\$8.85
00626	225mm long-closed one end	\$8.85
00630	Coupling 3/4" female/female	\$8.85
723R4140120	Lid Gasket	\$133.75

Astral Laterals- New Style

Part No	Description	Price
30775	Lateral, 1 1/2" X 3-9/16"	\$9.00
30776	Lateral, 1 1/2" X 6-5/16"	\$10.50
30777	Lateral, 1 1/2" X 8-7/8"	\$12.00
30778	Lateral, 1 1/2" X 10-1/4"	\$12.75
30779	Lateral, 1 1/2" X 12-13/16"	\$13.50
30780	Lateral, 1 1/2" X 14-3/16"	\$14.25
30781	Lateral, 1 1/2" X 17"	\$15.00
30782	Lateral, 1 1/2" X 18-3/4"	\$15.75
30783	Lateral, 1 1/2" X 21"	\$16.50



Swimquip Laterals

Part No	Diameter	Length	Price
24300-17	1 1/2"	8 3/8"	\$81.05
24300-18	1 1/2"	9 3/4"	\$81.05
24300-19	1 1/2"	15"	\$87.10
24300-21	1 1/2"	17"	\$93.95
24300-31	2"	13"	\$47.10
24300-32	2"	15"	\$51.05
24300-33	2"	17"	\$51.05
24300-34	2"	21"	\$54.45
24300-35	2"	23"	\$56.25
24300-36	2"	25"	\$73.25
24300-37	2"	30"	\$77.25

Longer laterals priced on request

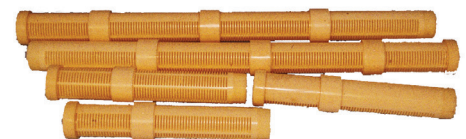

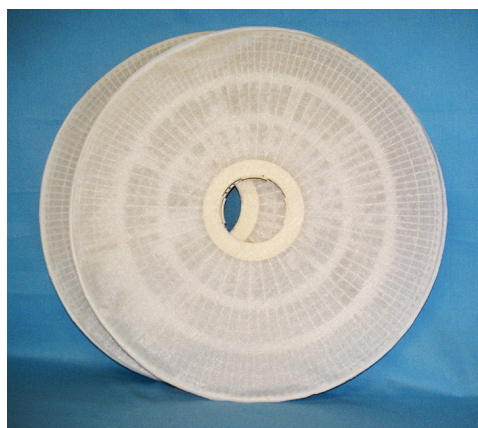

D.E. FILTER PARTS

D.E. Filter System Tips

- Good precoats are essential to getting clarity and to keeping septa clean.
- Normal dosage is 2 ounces per sq .ft. of filter area.
- Object is to deposit at least 1/16" over all parts of all element.
- Precoat filter at 1 U.S. GPM per sq. ft. of filter area.
- Maximum flow rate for filtration is 2 U.S. GPM per sq. ft. however 1 -1.5 GPM is better.
- Check for grease, metal staining, body oils, and other discolourations on filter elements. Buildup of dirt will shorten filter cycles.
- Check for warped or broken elements on a regular basis.

SwimQuip D.E. Filter Discs Complete

FOB Factory

Item No	Description	Size	Price	20+
FD-1510-00	*Filter Disc	14.5"D	\$46.40	\$41.67
FD-1620-00	*Filter Disc	16"D	\$53.32	\$47.75
FD-2600-33	Centre Disc	26"D	\$290.25	\$260.68
29330-0033	Spacer		Please inquire	

*When ordering please specify hub style or type.



D.E. Filter Covers

Item No	Description	Size	1-11	12+
11 07 01	Generic	30" x 60"	\$128.67	\$115.58
11 07 05	Gasket for	30" x 60"	\$8.75	\$7.00
VFC-3660-1	Generic BIF	36" x 60"	\$303.20	\$272.30
11 07 12	Generic	30" x 36"	\$111.40	\$100.05

Custom D.E. filter Covers. Available on request. Sample cover or element required for accurate sizing and pricing.

D.E. Filter Element Cores

FOB Factory

Item No	Description	Size	1-6	7+
11 07 03	Generic	30" x 60"	\$369.10	\$331.50
Item No	Description	Size	1-7	8+
PS3660	Generic BIF side outlet	36" x 60"	\$1163.05	\$1044.65
Item No	Description	Size	1-4	5+
11 07 09	Generic	30" x 36"	\$302.27	\$271.50

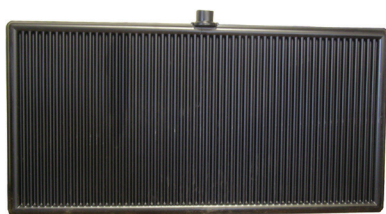

GENERIC 30 X 60 ELEMENT